



2019 Dufour 310

2 Cabins / 1 Head

BASIC SPECIFICATIONS

LOA	31'8"
Hull Length:	30'7"
LWL	28'6"
Beam	10'9"
Disp (Lbs)	10,802
Draft	6'4"
Ballast	2,932 lbs
Engine Power	19HP
Sail Area (Sq Ft)	543
Water (Gal)	42
Fuel (Gal)	24

*Complete equipment list available. Additional installed equipment quoted at buyer's request.

boatsales@tradewindsailing.com

Tradewinds Sailing School & Club, Inc .

REDUCE THE COST OF BOAT OWNERSHIP BY ALMOST 50%
THROUGH CHARTER PLACEMENT

ASK US FOR DETAILS

**DELIVERY
PACKAGE:**

California Delivery / Commissioning /
Bottom Paint Anchoring, Docking &
Safety Packs / Detail & Wax

VALUE PRICE: \$207,038

***Standard Equipment plus factory options
as shown include:**

SAILS & RIGGING

- Mast: Anodized aluminum with swept spreaders
- Rigging: 9/10 fractional
- Mast stepping: On deck
- Lights: Anchor and steaming lights and deck flood.
- Topping lift: Boom topping lift cleats.
- Boom: Anodized aluminum fitted with 2 continuous reefers.
- Furler: Genoa roller furler.
 - Standing rigging: Continuous in stainless single-strand cable, chrome-plated bronze rigging screws, comprising: forestay, twin backstay, inter. and lower shrouds.
- Preventer shroud: double
 - Running rigging: "Running rigging in pre-stretched textile including: main sail and self-tacking jib halyards, boom topping lift, main sail and self-tacking sheets, 2 continuous reef lines, leech tensioner, 2 main- sheet car adjustments, furling line, downhaul tackle."
- Mainsail: 2 wide reef strips, with battens
- Genoa: Furling genoa with UV-protection (Dacron).

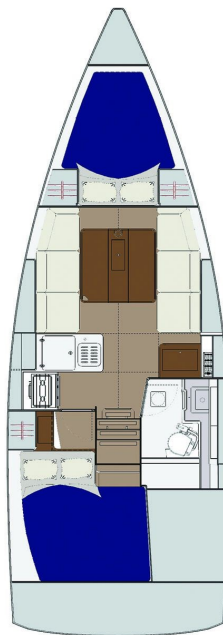

EXTERIOR EQUIPMENT

- Hand rails: Solid wood, on coachroof.
- Fixed toe rails: Wooden, at the hull/deck join.
 - Anchor locker: Self-draining with built-in windlass support and anchor chain eyebolt, lockable hatch cover.
- Bow pulpits: Seat and separate green/red navigation lights
 - Stern pulpits: Lifebuoy bracket, jackstaff bracket, navigation light, and opening life-lines with hook.
- Stanchions: 8 with 2 rows of life-lines.
- Mast foot: Aluminum with halyard return pulleys.
- Other: Solid wooden toe-rail.

INTERIOR EQUIPMENT

- Woodwork: Real wood veneer in Moabi, solid Moabi
- Floors: Moabi laminate.
 - Doors: Fitted with twin-bolt anti-vibration locks, cabin doors can be blocked in the open position
- Mattress: Mattresses are in quilted, anti-allergic fabric.
 - Cushions: Saloon cushions and cabin mattresses fitted with removable covers.
- Head-liner: White painted head-liner.
- Versions: 2 cabins, 1 head, port "L" galley

CALL BUTCH: 415-690-9923 or BRANDY: 510-415-1747